

Musley Hill, Ware, SG12 7NQ

Westwood Leber is delighted to bring to the market this fantastic three-bedroom, semi-detached family home, ideally located just a short walk from Ware Town Centre.

The property has been thoughtfully extended and tastefully updated throughout by the current owners. The accommodation comprises a spacious lounge, a fabulous open-plan kitchen/dining room, a utility room, a refitted first-floor bathroom, and three good-sized bedrooms. Externally, the property boasts a magnificent, recently landscaped rear garden, featuring a lawn area, a large AstroTurf section for year-round use, and a lovely, sociable patio area that leads out from the kitchen's bi-fold doors. To the front, there is a driveway offering off-street parking.



WESTWOODLEBER

Ground Floor

Approx. 53.8 sq. metres (579.6 sq. feet)

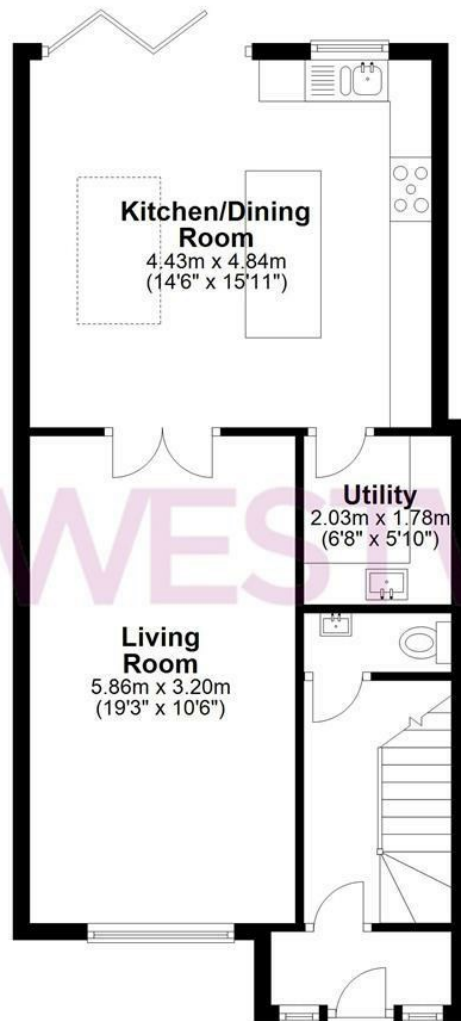

First Floor

Approx. 31.7 sq. metres (341.0 sq. feet)

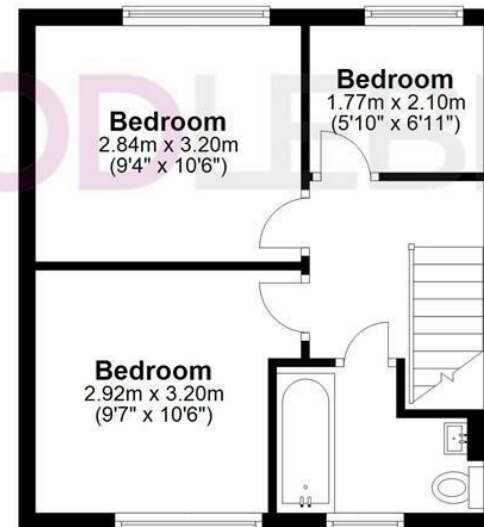

Total area: approx. 85.5 sq. metres (920.6 sq. feet)

THE FLOORPLAN IS FOR ILLUSTRATIVE PURPOSES ONLY AND IS NOT TO SCALE. Measurements and features are approximate and may differ from the actual property. Verify all details independently; no liability is accepted for errors or omissions.

Property marketing provided by www.fotomarketing.co.uk
Plan produced using PlanUp.









